

Aqua FountainTM

INSTRUCTIONS FOR ASSEMBLY AND OPERATION



4120 NW 44th Lincoln, NE 68524
www.mypurewater.com
402-467-9300

IMPORTANT NOTE: CAUTION

BEFORE STARTING THE MACHINE; YOU MUST REMOVE THE BRACKET SUPPLIED TO SECURE THE ACTUATING ARM OF THE DISTILLED WATER STORAGE TANK.

CHECK TO MAKE SURE THE FLOAT MECHANISM IS FREE MOVING WITHIN THE HIGH AND LOW LEVEL LIMITS AFTER BRACKET REMOVAL.

PLEASE USE CAUTION WHILE REMOVING THE RESTRAINING BRACKET SO THAT YOU DO NOT ACCIDENTALLY LOOSEN ANY INTERIOR WIRING!

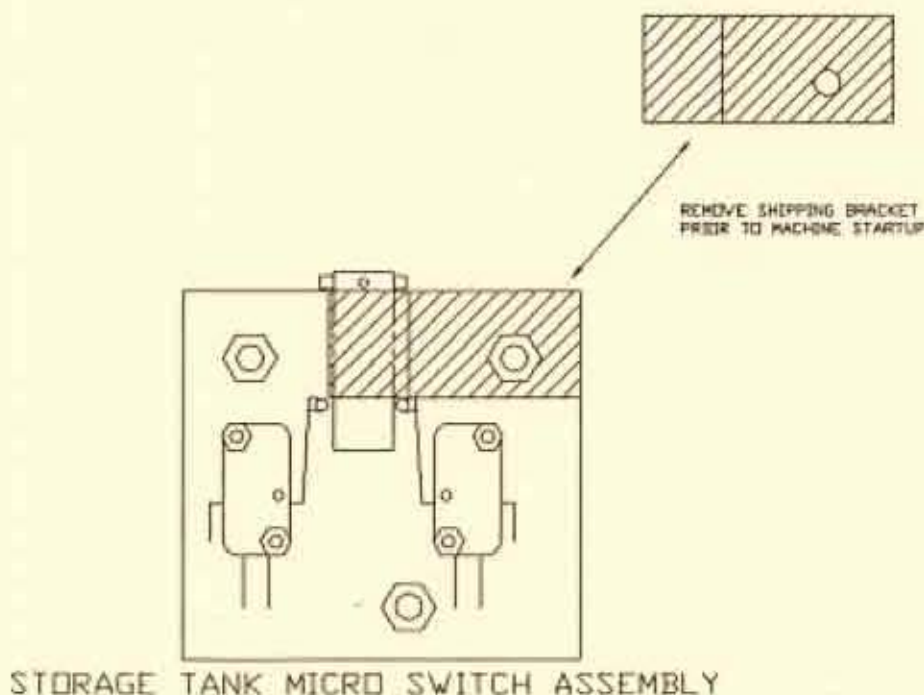

**Model and serial number may be found
at the left side of the base.**

**You should record both model and
serial number below for future use.**

Model: _____

Serial Number: _____

- 1) PLEASE READ ALL INSTRUCTIONS THOROUGHLY BEFORE ASSEMBLING AND OPERATING YOUR NEW UNIT. KEEP THESE INSTRUCTIONS FOR FUTURE USE.
- 2) It is important to fill out and return the warranty card which is included with your instructions. This information is very helpful to us should you ever need parts or repairs for your machine.
- 3) Your distiller has been checked at the factory for leaks, proper working procedure, etc. Therefore, it may have a water ring.
- 4) The tank is heliarc welded and as you distill water, the mineral content may cling to the heliarc weld and will appear to be rust. This is T-304 Stainless Steel and what may appear to be rust is the mineral content clinging to the seams.
- 5) DO NOT subject your unit to misuse or abuse. Proper cleaning is very important and instructions are included as a part of this booklet.
- 6) When some people start drinking distilled water, they seem to think it has a taste; usually, this is not taste but a lack of taste. The taste buds will become accustomed to this the same as they did to the water in your area.
- 7) PLEASE GIVE CLOSE ATTENTION TO THE FOLLOWING ELECTRICAL PRECAUTIONS:
 - a. Never immerse the unit in water or any other liquid.
 - b. Never operate an appliance with a damaged cord. Do not let the cord hang over a sharp edge, such as a counter top or table, or be exposed to hot surfaces.
 - c. Do not use an extension cord.
 - d. The unit should not be operated outdoors or be exposed to the natural elements (rain, snow, and so forth).
 - e. THIS ELECTRICAL APPLIANCE, LIKE ALL OTHERS, SHOULD BE GROUNDED!

**THIS UNIT SHOULD NOT BE OPERATED AND FILLED DIRECTLY
FROM THE KITCHEN SINK WITH THE UNIT CONNECTED TO AN
ELECTRICAL SOURCE AS AN EXTRA PRECAUTIONARY MEASURE.**

CONNECTING TO POWER SOURCE OUTLET

This unit must be grounded while in use to protect the operator from electrical shock. If power cord is worn or cut, or damaged in any way, have it replaced immediately.

Your unit has a plug that looks like the one illustrated below.

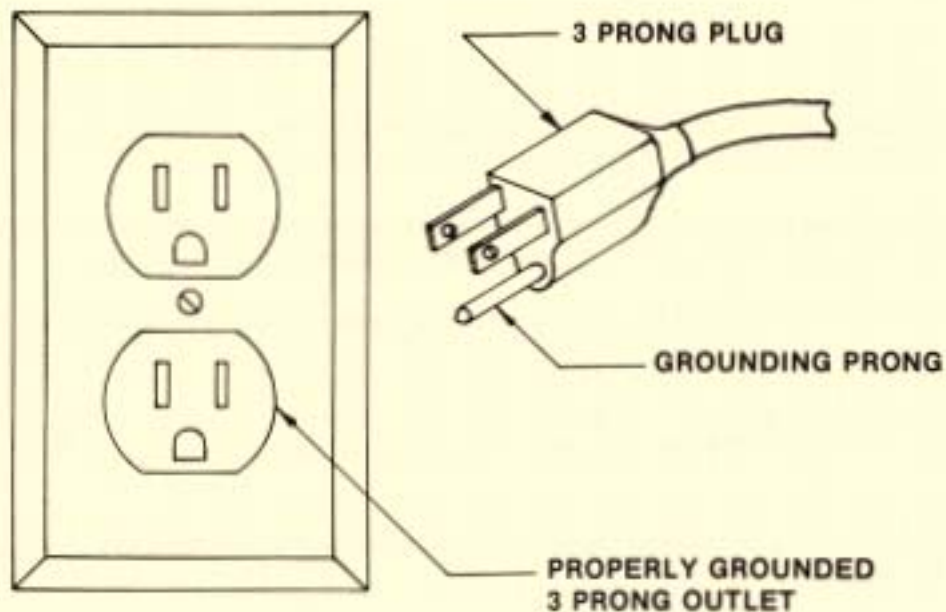

Plug power cord into 120V properly grounded type outlet protected by a 20-amp. time delay or circuit-saver fuse or circuit breaker.

IF YOU ARE NOT SURE THAT YOUR OUTLET IS PROPERLY GROUNDED, HAVE IT CHECKED BY A QUALIFIED ELECTRICIAN.

WARNING: DO NOT PERMIT FINGERS TO TOUCH THE TERMINALS OF PLUG WHEN INSTALLING OR REMOVING THE PLUG TO OR FROM THE OUTLET.

This unit is equipped with a 3-conductor cord and grounding type plug which has a grounding prong, approved by Underwriters Laboratories and the Canadian Standards Association. The ground conductor has a green lug and is attached to the base at one end and to the ground prong in the attachment plug at the other end.

This plug requires a mating, 3-conductor grounded type outlet as shown.

You will notice that the condensing coil, located inside the unit at the left (as you face the front of the unit), will have two small holes drilled in its top. These holes are not defects, rather they are provided to release certain volatile gases. Should some steam escape from these holes, this should be of no alarm to you.

Although we inspect these machines before leaving the factory, we are subject to human error. So, should there be any defects or missing parts to your machine, correspond directly with Pure Water, Inc., 3725 Touzalin, P.O. Box 83226, Lincoln, NE 68501.

FIGURE 1 FRONT VIEW OF AQUA FOUNTAIN AS SHIPPED



Figure 1

<u>Key No.</u>	<u>Part Name</u>
1	Boiling tank opening
2	Dispenser switch
3	Drinking water dispenser
4	Reset
5	Boiling tank drain nipple
6	Heating element switch
7	Momentary water switch
8	Holes for waste water catcher clips
9	Valve coupling for storage tank

FIGURE 2 REAR VIEW OF AQUA FOUNTAIN AS SHIPPED



Figure 2

<u>Key No.</u>	<u>Part Name</u>
10	Pump switch
11	Fan switch
12	Main circuit breaker
13	Boiling tank drain extension tube
14	Inline filter
15	Auxiliary water outlet
16	Temperature control knob
17	Power cord

FIGURE 3 CONTENTS SHIPPED IN WATER CATCHER

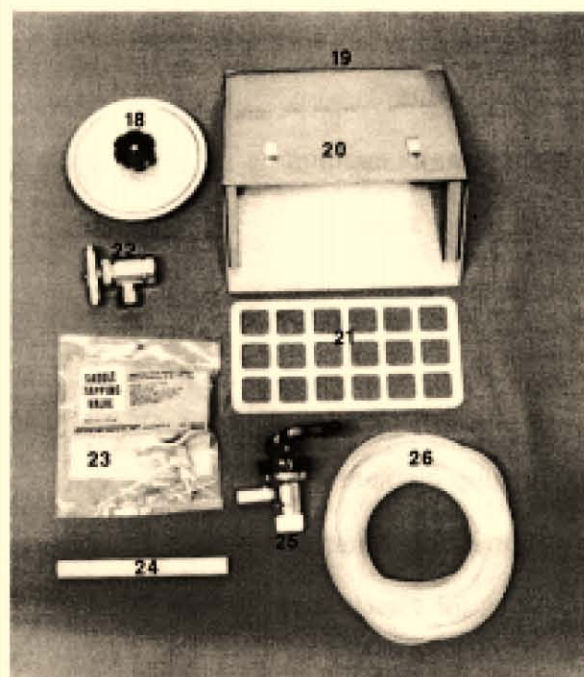

Figure 3

Key No.	Part Name
18	Boiling tank lid
19	Water catcher
20	Water catcher clips
21	Water catcher screen
22	Boiling tank drain valve
23	Saddle tapping valve kit
24	Drain valve tighten valve
25	Distilled water drain valve
26	1/4" EVA water line tubing

FIGURE 4 BOILING TANK DRAIN EXTENSION TUBE ASSEMBLY

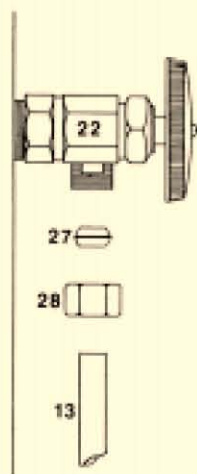

Figure 4

Key No.	Part Name
13	Boiling tank extension tube
22	Boiling tank drain valve
27	3/8" brass sleeve
28	3/8" compression nut

FIGURE 5 EVA WATER LINE TUBING TO SADDLE TAPPING VALVE

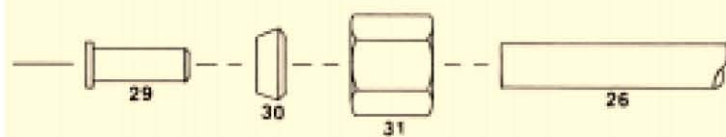

Figure 5

Key No.	Part Name
26	1/4" EVA water line tubing
29	Brass insert
30	Delrin sleeve
31	1/4" compression nut