

Installation



CAUTION: The Midi-Classic weighs approximately 42 lbs. Please use caution when removing it from the carton to prevent injury.

1. Open the carton.
2. Carefully lift the distiller out of the box so it remains in the upright position.
3. Remove and identify all parts kits as listed on page 4.
4. With a pliers, remove the black plug in the fitting marked “Distilled Water Outlet”. If you are not installing a demand pump, insert the grey plug, located in the parts kit bag, into the fitting. Pump installation information is discussed later in this manual.
5. Remove the wire tie inside the boiling tank used to restrain the float during transit.

Connecting the Incoming Water Line

Notes and Cautions:

Note: The use of softened water for the raw water supply is recommended to minimize scale build-up in the boiling tank and drain valve.

Note: The Midi-Classic comes standard with a saddle tapping valve. In some areas a saddle tapping valve may not be permitted. In such instances, contact your authorized Pure Water Distributor for other water line connection options.

Note: Do not plug the unit into the power source until instructed to do so.

CAUTION: DO NOT use a hot water line for your supply line.

CAUTION: DO NOT turn the saddle tapping valve handle before or during installation. Be sure the piercing lance does not protrude beyond the rubber gasket. Failure to do this may result in damage to the piercing needle.

To hook-up the Incoming Water Line:

1. Locate the items in the parts kit bag as identified on page 4 as “Incoming Water Hook-Up”.
2. Turn the household water supply OFF.
3. Remove the blue plug in the fitting marked “Raw Water Inlet”.
4. Install the 1/4” speedfit elbow onto the fitting. Pull to test. See figure 6.

Caution: Never use the hot water line for your incoming water.

5a. For installation on *copper pipes*:

- a. Assemble the saddle tapping valve on the **cold** water pipe so the outlet is in a convenient direction. See figure 5.
- b. Tighten the screws evenly so the brackets are parallel. Tighten firmly, but do not overtighten.
- c. Connect the 25' of 1/4" plastic tubing to the saddle tapping valve.
- d. Cut the required length of tubing to run from the saddle tapping valve to the distiller, but make sure you coil a minimum of 8 feet of tubing behind the distiller to allow it to be moved away from the wall for cleaning or service.
- e. Cut a one foot piece of 1/4" tubing off the end of the tubing to allow the strainer to be installed.
Note: You may also use a piece of tubing that was cut in step d.
- f. Install the one foot piece of tubing into the elbow on the Raw Water Inlet. Pull to test. See figure 6.
- g. Install a 1/4" compression nut onto the tubing coming from the distiller. See figure 7.
- h. Install the tubing onto the strainer. See figure 8. Make sure the tubing is inserted fully into the strainer and the flow is in the correct direction. Tighten the nut firmly.
- i. Install a 1/4" compression nut onto the tubing coming from the saddle tapping valve and connect to the inlet stem of the strainer. Tighten firmly. See figure 9.
- j. Turn the saddle tapping valve handle clockwise until you feel it is firmly seated. **Note:** You have now pierced the water supply line and the valve is closed.
- k. Turn the handle counterclockwise to open the valve. Turn on the household water supply and check the connections for leaks. Tighten where required.

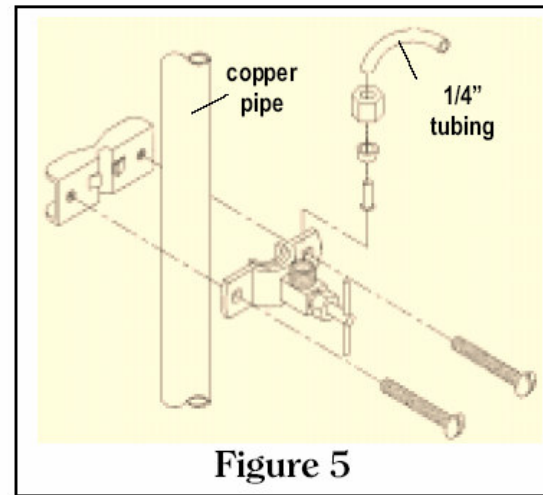

Figure 6



Figure 7



Figure 8



Figure 9

5b. For installation on **brass, steel, or PVC pipes**:

Note: Make sure the water supply is turned off and drain the line. Make sure you are using the **cold** water line.

- a. Drill a 3/16" hole in the pipe. Use a hand drill to avoid shock hazard.
- b. Turn the saddle tapping valve handle to expose the lance beyond the rubber gasket no more than 3/16".
- c. Assemble and place the body of the valve over the hole so the lance fits into the hole. Make sure the outlet is in a convenient direction. See figure 5.
- d. Tighten the screws evenly so the brackets are parallel. Tighten firmly, but do not overtighten.
- e. Turn the saddle tapping valve handle clockwise to close the valve.
- f. Connect the 25' of 1/4" plastic tubing to the saddle tapping valve.
- g. Cut the required length of tubing to run from the saddle tapping valve to the distiller, but make sure you coil a minimum of 8 feet of tubing behind the distiller to allow it to be moved away from the wall for cleaning or service.
- h. Cut a one foot piece of 1/4" tubing off the end of the tubing to allow the strainer to be installed. **Note:** You may also use a piece of tubing that was cut in step d in the previous section.
- i. Install the one foot piece of tubing into the elbow and pull to test. See figure 6.
- j. Install a 1/4" compression nut onto the tubing coming from the distiller. See figure 7.
- k. Install the tubing onto the strainer. See figure 8. Make sure the tubing is inserted fully into the strainer and the **flow** is in the correct direction. Tighten the nut firmly.
- l. Install a 1/4" compression nut onto the tubing coming from the saddle tapping valve and connect to the inlet stem of the strainer. Tighten firmly. See figure 9.
- m. Turn the handle counterclockwise to open the valve. Turn on the household water supply and check the connections for leaks. Tighten where required.

Installing the Boiling Tank Drain Valve

1. Remove the blue plug from the fitting marked “Boiling Tank Drain” on the back of the unit.

Note: Ensure that Teflon tape has been applied to the threads of the fitting on the drain valve.

2. Locate the drain valve from the parts kit bag and install it onto the boiling tank drain fitting . Tighten using an adjustable wrench. **Note:** Tighten until the outlet is pointing down.

3. Insert the drain extension tube into the drain valve.

Note: Make sure the compression sleeve is on the drain tube.

4. Holding the tube in place, tighten the nut with a 5/8” wrench until the tube is secure. See figure 10.

5. Loosen the nut slightly so the extension tube can be rotated, yet is secure.



Figure 10

Installing the Storage Tank Faucet

1. Locate the faucet and rubber washer in the parts kit bag. Install the rubber washer onto the stem of the faucet.
2. Remove the red plug in the fitting on the front of the Midi-Classic.
3. Install the faucet into the fitting by rotating the faucet clockwise until tight and the sight glass is in the proper vertical position. See figure 12. **Note:** Do not twist the faucet by the sight glass. It is fragile.



Figure 11

Connecting the Power Cord

Note: On some 240V units, the power cord may be sold separately and not included in the part kit bag. Ensure the Power Switch is turned to the OFF position. See figure 14 on next page.

1. Locate the power cord in the parts kit bag. Install the female end of the power cord into the outlet on the back of the unit marked “Power Cord Plug”. See figure 11.

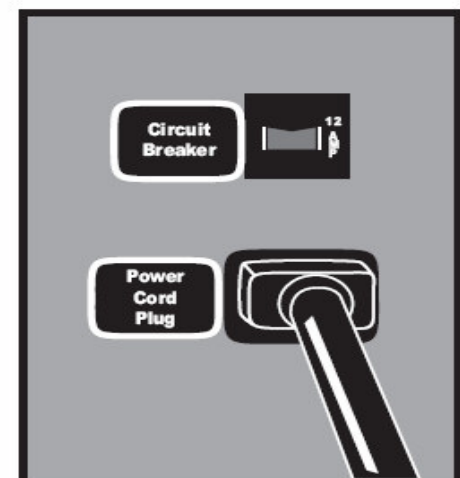

Figure 12