

DIRECTIONS

For Use of

PWS Portable Distiller

(Please Follow Carefully)

This unit has been test-run at the factory in order to inspect its parts and assembly. The user is encouraged to sterilize this unit prior to its regular use. See directions below for steam sterilizing. Be sure the containers for catching the distilled water have been thoroughly washed with hot, soapy water and rinsed well.

DISTILLING CYCLE

1. Remove lid -- fill with water to level gauge.
2. Replace lid -- make sure lid is fit in proper groove or steam will escape.
3. Be sure reset button is pushed in.
4. Switch fan to on position.
5. Turn timer to left. (on position) Still produces 1/2 gallon distilled water in 1-1/2 hours, or 1 gallon in 3 hours.
6. Assemble rack on side of unit.
7. Place outlet water tube into user's container.
8. Plug cord into electrical outlet.
9. Collect distilled water.

STEAM STERILIZING CYCLE

Follow above directions, with the exception of step 4, and then turn off fan. This will allow the steam to pass through the condensing coils and sterilize the unit.

CAUTION: Do not plug the unit into electrical outlet unless water in tank is of proper depth. (To do so would shorten the life of the heating element unnecessarily.)

DISTILLING CYCLE DIRECTIONS

Fill tank with water you wish to distill up to bottom of water level gauge and fasten lid. Filling water above bottom of level gauge may allow undistilled water to flow into condensing coils and out into user's container. Do Not Overfill. If warm water is used, it will take less time for distillation.

This unit should be operated in a spot away from other heat sources. The lower the temperature of the room, the better for distillation.

Plug Still cord into 115 volt AC single phase electrical outlet. Push reset button to start machine. Reset button should have been pushed in at factory. (During distillation, the fan switch must be in the "ON" position so that the condensing fan will run.) The unit will shut off in about hours. Refill with water and reset timer by turning dial to the left up to the stop point.

Should the Still become overheated, it will shut off automatically. To restart, let the machine cool down to operating temperature, then fill with water. Reset button must be pressed to restart the machine if it becomes overheated. In order to speed up the restart, the tank may be drained and refilled with cool water.

Although the mineral build-up will vary with each area, the PWS Distiller tank should be drained periodically -- possibly after every third run. The drain valve on the outside of the tank end of the unit is used for this purpose only. (Make certain the heating element is free of mineral build-up as this could shorten the life of the element.)

The timer incorporated into the machine will provide several advantages.

The machine would be set for hours of distilling and after the timer has shut off the machine, it can be restarted without cooling. The use of warm water will decrease the time it will take to start distilling. The water level will remain above the heating element providing a coolant for the element. The timer and reset would act as a dual safety for the machine. We feel with the use of a timer the life of this unit will be extended.

CAUTION:

1. This machine, like all electrical appliances, should be grounded.
2. Do not use an extension cord.
3. A three prong plug to two prong adapter is provided. (This is for outlets not wired for three prong grounded plug.) When using this adapter the short lead must be grounded.

OPERATING INSTRUCTIONS

- Plastic sleeve for condensing coil will fit very snugly, so dip in hot water to soften plastic first.
 - Slide extension tube with seal on end over condensing coil outlet tube.
 - Extension tube must be pushed on until it is tight against the fin.
- All tubes are stainless steel.

CONDENSING
COIL OUTLET

FIN

PLASTIC
SEAL

CONDENSING COIL

EXTENSION
TUBE



LID

TANK FILL

WATER LEVEL

EXTENSION TUBE
SLIDES OVER
CONDENSING
COIL OUTLET

DISTILLED
WATER OUTLET

STEAM VAPOR
INTAKE

RESIDUE OF
POLLUTANTS

TANK
DRAIN

FAN

TIMER

FAN
SWITCH

RESET
BUTTON

BRACKET HOOKS
OVER VENT
OPENINGS IN
FRONT OF
MIDI-STILL

CONDENSED
VAPOR
DROPLET

Bottle
Not Furnished

PURE
DISTILLED
WATER

- 1 Remove lid—fill water up to level gauge.
- 2 Replace lid—make sure lid is fit in proper groove or steam will escape.
- 3 Be sure reset button is pushed in.
- 4 Switch fan to on position.
- 5 Turn timer to left. (on position) It produces 1/2 gallon of distilled water in 1 1/2 hours or 1 gallon in 3 hours.



**PURE WATER
SOCIETY, INC.**

P.O. Box 83228 3725 Touzalin
Lincoln, Nebraska 68501 (402) 467-2577

Parts & Wiring Diagram

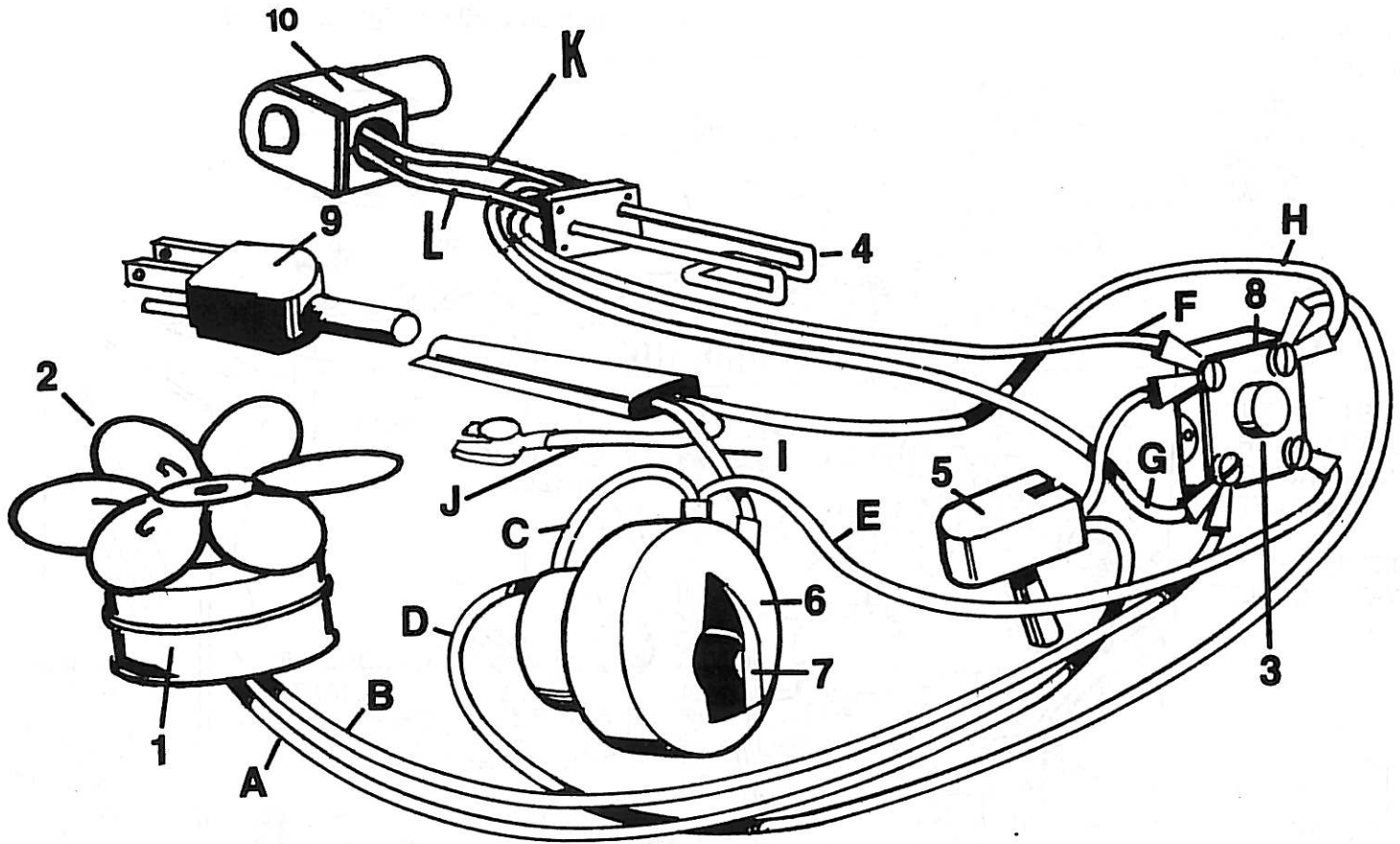

A Fan Motor Wire
 B Fan Motor Wire
 C Timer Motor Wire
 D Timer Motor Wire
 E Timer to Reset Switch Wire
 F Heating Element Wire
 G Heating Element Wire
 H Main Cord Wire to Reset Switch
 I Main Cord Wire to Timer
 J Main Cord Ground Wire
 K Soleniod Valve Wire
 L Soleniod Valve Wire

1 Motor
 2 Fan Blade
 3 Reset Switch
 4 Heating Element
 5 Fan Switch
 6 Timer
 7 Control Knob
 8 Heat Plate
 9 Main Cord
 10 Soleniod Valve

PWS Parts List

<u>Part #</u>	<u>Description</u>
<u>Price</u>	
68	Bib washer
509	Bottle Hook
636	Cap nuts (4 pak)
607	Condensing coil w/ fittings
517	Condensing coil extension tube
6010	Cover gasket, boiling tank
9508	Drain valve, side
95	Drain valve, bottom
518	Drain valve extension tube
639	Fan blade w/ fastener
653	Fan motor w/ blade & conn.
642	Fan switch, plastic
71	Fan switch, toggle style
633	Heating element w/ gasket & clamp
642	Heating element switch
8010	Legs, black plastic
9081	Leg riser, metal
409	Lid complete
610	Lid knob w/gasket, washer & o ring
402	Lid crossbar w/stud
7039	Reset
638	Screws, sheetmetal (12 pak)
637	Speed clips (12 pak)
640	Timer w/ conn.

Retail orders to be shipped prepaid or C.O.D.

Prices subject to change without notice
Parts subject to availability